

KS1000TB Vertically Laid

Fixing Method

Every other brick in the fourth course is fixed directly to the panel approximately 1/3 in from the end of the brick. Thereafter, every fourth course of thermabrick is fixed as before with the fixings starting from opposite ends to stagger the fixings up the wall.

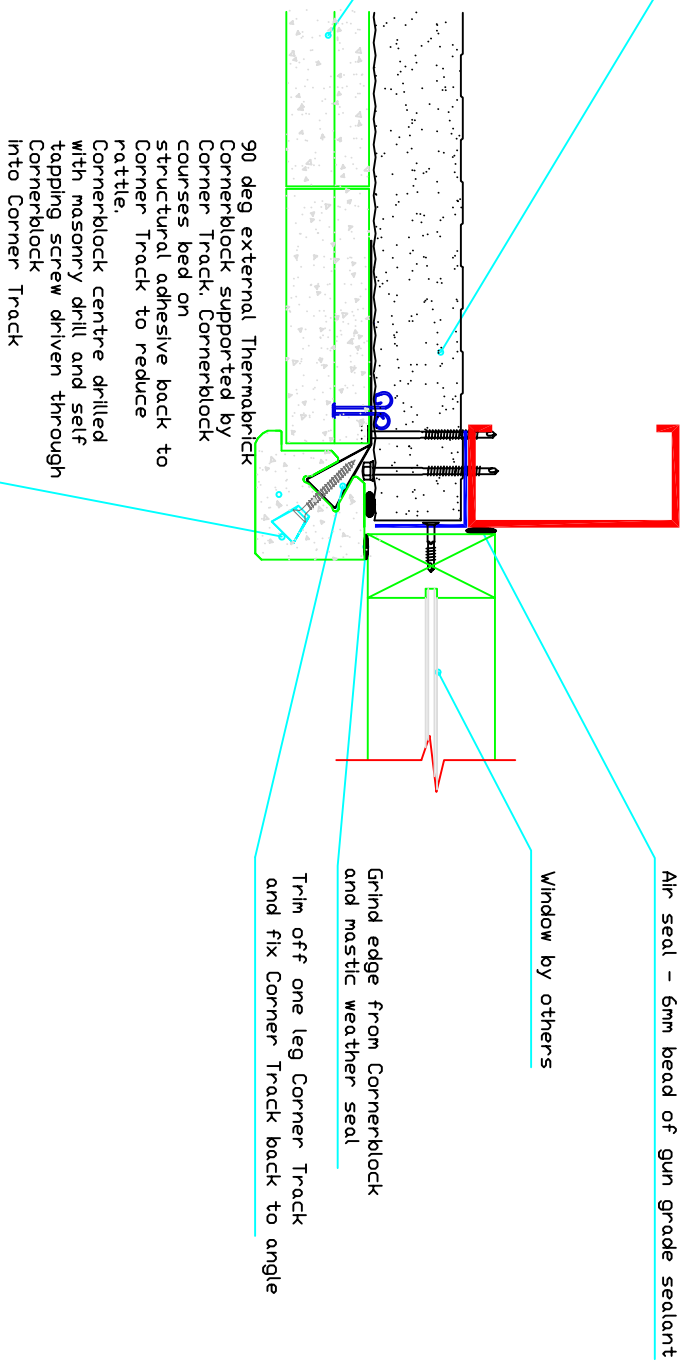

Project :

Drawing Title: Thermabrick Window Jamb Detail

Drawing: CC Checked:

Date: 7/1/07

Drawing No.: TB10

Rev: A



Greenfield Business Park Nr. E, Greenfield Holywell, Flintshire. CH8 7GJ Tel: 01352 716 101 Fax: 01352 716 111

